

DM12 DOVETAIL FIXTURE		
ITEM NO.	DESCRIPTION	QTY.
1	SHCS, M5-0.8 X 25MM	1
2	FLAT WASHER, M5	1
3	CLAMP, DM12	1
4	SPRING, DM12	1
5	BASE, DOVETAIL FIXTURE	1
6	SHCS, M5-0.8 X 20MM	2
7	DOWEL PIN, 3MM X 6MM DM12	1
8	DOWEL PIN, 3MM X10MM DM12	2
9*	CLAMP KIT, DM12 (P/N: CA10M-R)	1
MINIMUM STOCK SIZE: 12 MM X 12 MM		
MAX TORQUE: 8 N-m		
INDICATED PARTS SOLD BY 5TH AXIS FOR REPAIR		

5thAXIS[®]
 DM12 DOVETAIL
 PARTS ASSEMBLY
 DRAWING/PARTS LIST
 STOCK PREP
 MOUNTING

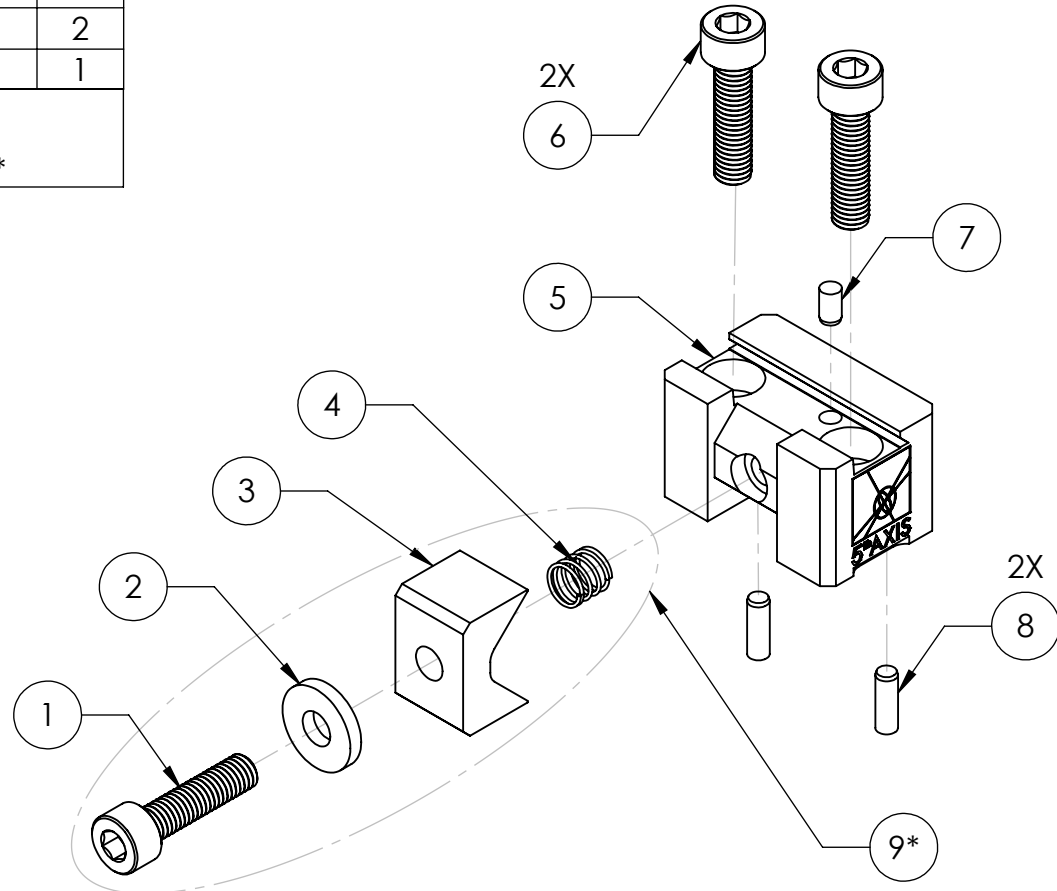
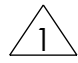

DOVETAIL STOCK PREP FOR DM12

 PROGRAM TO THEORETICAL SHARP DOVETAIL (5.2) AND CUTTER DIAMETER (45.5 FOR DC1750-45)

